

## 1. KBSOUND STAR App Installation



ANDROID DEVICES

iOS DEVICES



Tap the Google Play Store on the ANDROID Device to download the KBSOUND STAR App.



Tap the Apple App Store on the iOS Device to download the KBSOUND STAR App.

## 3. Listen FM/DAB

Turn on the Master and select the FM/DAB channel.

Current FM tuner station frequency

jump to the FM FAVORITES SCREEN

RDS information about current FM tuner station

FM sensitivity for scan

jump to the EQ SCREEN

volume

ON / OFF audio channels buttons

add/remove FM favorites (long press 4" to remove)

manual dialing

scan

FM forced mono

jump to the SETTINGS SCREEN

set ideal mode (long press 4" save ideal mode)

Bluetooth ID. Tap to open the window which will show the devices available and allows you to connect with another one if you wish.

## 2. Bluetooth Pairing and Connection

- 1 Be sure that the MASTER is powered and in range for Bluetooth connection.
- 2 Tap the KBSOUND STAR App on the device.
- 3 Tap the "Pair a new device" button.
- 4 Select the MASTER. The ID and password can be found on the label attached and on the MASTER unit.
- 5 Select the previously paired device.
- 6 The App is now ready to operate the MASTER to listen FM/DAB.

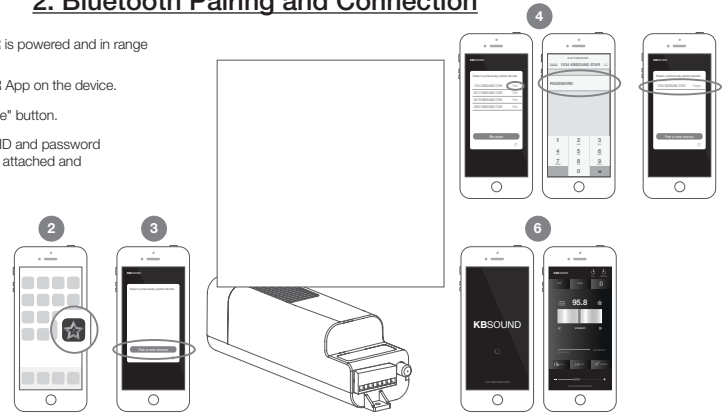

## 4. Listen Bluetooth Audio Streaming

1. If you wish to stream music select the Bluetooth audio channel.
2. Connect the Bluetooth device for streaming (smartphone, computer, amazon alexa devices, ...) to the MASTER. The ID and password are the same found on the label attached.
3. Go to the settings in your Bluetooth device and pair the device you wish to use for Bluetooth Audio streaming.

